

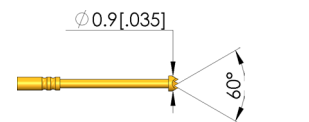

GO TO PRODUCT

- Robust, compact design for harsh ICT/FCT applications with limited space
- For optimum contact at the test points (e.g. pads, vias, and pins), various tip styles in different diameters and finishes, as well as various spring forces are available. spring forces.

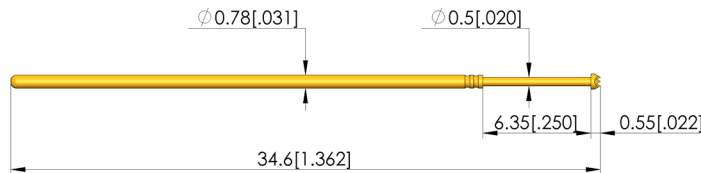
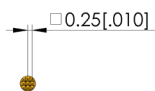

### General data

Product group: ICT / FCT (in-circuit test and function test)  
 Sub-product group: Bead probe  
 Series: GKS-550  
 Grid: 1.27 mm [50 mil]  
 Contacting from: Post  
 Magnetic: Yes  
 Installation type: Plug-in  
 Quick-exchange system: Yes  
 Adjustable installation height: No  
 Non-rotating: No  
 Compatible receptacle(s): KS-550 WL  
 Min. temperature: -40 °C [-40 °F]  
 Max. temperature: 80 °C [176 °F]  
 RoHS-compliant: Yes

Product group: ICT / FCT (in-circuit test and function test)  
 Sub-product group: Bead probe  
 Series: GKS-550  
 Grid: 1.27 mm [50 mil]  
 Contacting from: Post  
 Magnetic: Yes  
 Installation type: Plug-in  
 Quick-exchange system: Yes  
 Adjustable installation height: No  
 Non-rotating: No  
 Compatible receptacle(s): KS-550 WL  
 Min. temperature: -40 °C [-40 °F]  
 Max. temperature: 80 °C [176 °F]  
 RoHS-compliant: Yes

### Tip style data

Tip style: 60 serrated, small grid  
 Tip diameter: 0.9 mm [.035 in]  
 Tip style surface: A gold  
 Tip style material: 3 CuBe

### Electrical data

Current load capacity / rated current: 3 A  
 Typical resistance (Ri): 20 mOhm

### Mechanical data

Total length: 34.6 mm [1.36 in]  
 Barrel diameter: 0.78 mm [.03 in]  
 Maximum stroke: 6.35 mm [.25 in]  
 Spring pre-load: 0.66 N [2.37 ozf]  
 Collar height: 0.55 mm [.022 in]  
 Spring force at working stroke: 1.5 N [5.39 ozf]  
 Recommended working stroke: 4.3 mm [1.69 in]

### INGUN Prüfmittelbau GmbH

Max-Stromeyer-Straße 162  
 78467, Constance, Germany  
 Phone +49 7531 8105-0  
 Customer hotline +49 7531 8105-888  
 Fax +49 7531 8105-65  
 info@ingun.com



Learn more about  
 ICT/FCT Test probes

