



GO TO PRODUCT

Durchgangsprüfung

Zur Überprüfung von möglichen offenen Verbindungen, Kurzschlüssen und Fehlverdrahtungen

- Robust test probes with distinctive collar (stop) on the barrel
- Optimum adjustment of the stroke ratios in the test fixture: The collar is available in different heights, which, in combination with the receptacles, allows a range of installation heights
- Version with central beading ensure low wobble for contacting small test points
- Stainless steel versions for temperatures from -100 °C up to +200 °C available

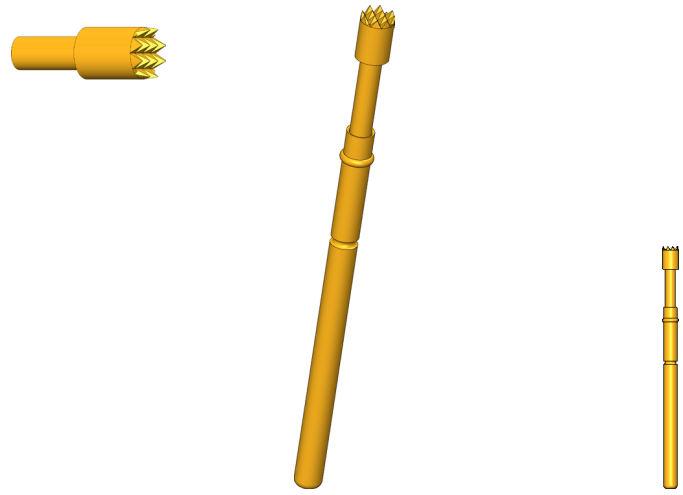

1:1

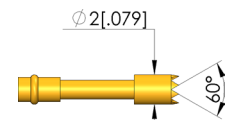
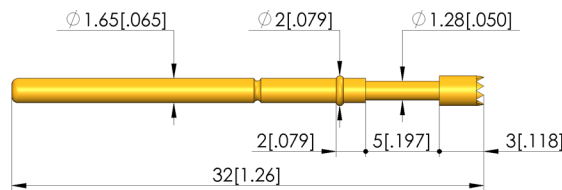
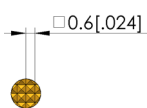

General data

Product group:
Sub-product group:
Series:
Grid:
Contacting from:
Magnetic:
Installation type:
Quick-exchange system:
Adjustable installation height:
Non-rotating:
Compatible receptacle(s):
Min. temperature:
Max. temperature:
RoHS-compliant:

ICT / FCT (in-circuit test and function test)
Metric standard
GKS-912
2.54 mm [100 mil]
Post
Yes
Plug-in
Yes
No
No
KS-112
-40 °C [-40 °F]
80 °C [176 °F]
Yes

Tip style data

Tip style:
Tip diameter:
Tip style surface:
Tip style material:

06 serrated
2 mm [.078 in]
A gold
3 CuBe

Electrical data

Current load capacity / rated current:
Typical resistance (Ri):

5 A
20 mOhm

Mechanical data

Total length:
Barrel diameter:
Maximum stroke:
Spring pre-load:
Collar height:
Spring force at working stroke:
Recommended working stroke:

32 mm [1.25 in]
1.66 mm [.065 in]
5 mm [.196 in]
0.5 N [1.79 ozf]
02
1.5 N [5.39 ozf]
4 mm [.157 in]

Test Probe

GKS-912 306 200 A 1502

Item GKS-912-0596



GO TO PRODUCT

ingun®

Partner for Future Technology

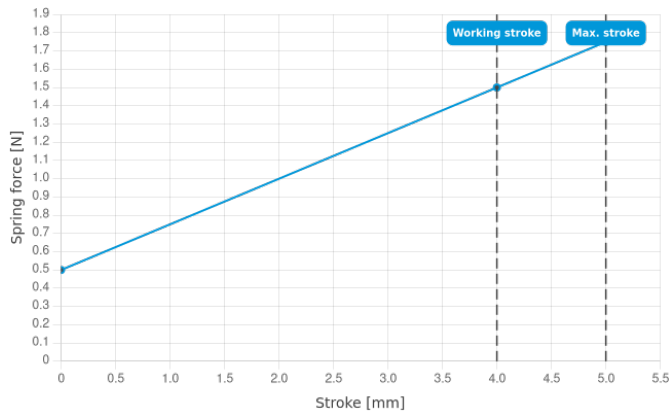

INGUN Prüfmittelbau GmbH

Max-Stromeyer-Straße 162
78467, Constance, Germany
Phone +49 7531 8105-0
Customer hotline +49 7531 8105-888
Fax +49 7531 8105-65
info@ingun.com



Prices and delivery times on request.
Technical changes reserved. 06/26_GB

Learn more about
ICT/FCT Test probes



ingun.com