

Push rod NHS-ST-60,0-4,0-KU-AL-ESD

Item 23190



GO TO PRODUCT

ingun[®]

Partner for Future Technology

- Trusted push rods for reliable, rigid fixing of the PCB in the probe field against the force of the test probes
- Robust, pressure-resistant design
- Quick, easy installation

Application

Push rods (NHS) are used in customisations to securely hold electronic circuit boards in place against the force of the test probes during contacting in the test fixture. Push rods are mounted in the pressure frame plate.

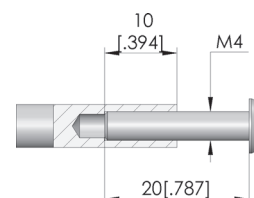
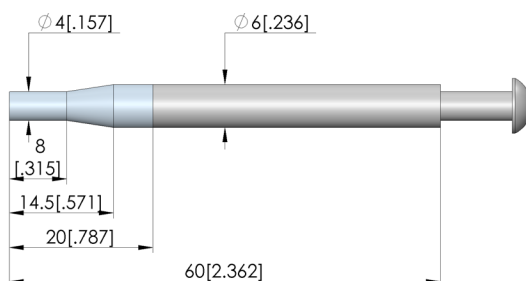
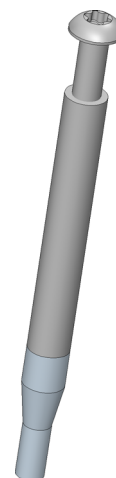

General data

Product group: Push rods (NHS)
 Series: NHS-ST
 Type: Rigid
 Version: ESD (Customising accessories)
 Accessory type: Customising accessories
 Outer dimensions (TxL): 6 x 60 mm [2.36 x 2.36 in]
 Colour: Untreated

Compatible with

Exchangeable kits version: ESD
 Manual test fixtures (MA): MA 20xx
 MA exchangeable kits (ATS MA): ATS MAxx

Technical data

Tip diameter: 4 mm [.157 in]
 Pushrod shaft diameter: 6 mm [.236 in]
 Tip material: KU
 Shaft material: AL
 True running: 2768 mK
 Installation: Screwed in
 Thread: M4x10 mm
 Tip length: 20 mm [.787 in]

Mechanical data

Total length: 60 mm [2.36 in]

INGUN Prüfmittelbau GmbH

Max-Stromeyer-Straße 162
 78467, Constance, Germany
 Phone +49 7531 8105-0
 Customer hotline +49 7531 8105-888
 Fax +49 7531 8105-65
 info@ingun.com

