

# Rear panel unit RWE MAxx09/11

Item 114919



GO TO PRODUCT

**ingun**<sup>®</sup>

Partner for Future Technology

## Application

Rear panel including installation accessories for manual test fixtures MA xxxx for modular test fixture configuration.

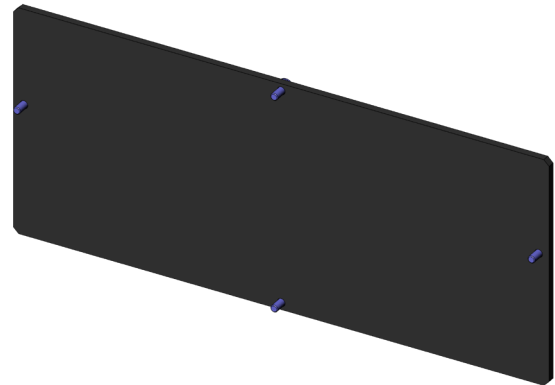

## General data

Product group:	Housing
Series:	RWE-MAxxxx
Type:	MA xx09/11
Accessory type:	Additional function
Scope of delivery:	Unassembled
Material:	Adaptonit 105-AS
Width:	304 mm [11.9 in]
Height:	128 mm [5.03 in]
Weight:	0.3 kg [.661 lbs]
Min. temperature:	10 °C [50 °F]
Max. temperature:	60 °C [140 °F]
RoHS-compliant:	Yes

## Compatible with

Manual test fixtures (MA): MAxx11

## Technical data

Length: 4 mm [.157 in]  
Outer dimensionS (WxDxH): 304 x 4 x 128 mm [11.9 x .157 x 5.03 in]

## INGUN Prüfmittelbau GmbH

Max-Stromeyer-Straße 162  
78467, Constance, Germany  
Phone +49 7531 8105-0  
Customer hotline +49 7531 8105-888  
Fax +49 7531 8105-65  
info@ingun.com



Prices and delivery times on request.  
Technical changes reserved. 05/26\_GB

Learn more about  
Test fixture kits

