

Interface support

SSA-KMFT-MAx13

Item 114090



GO TO PRODUCT

ingun[®]

Partner for Future Technology

- Interface support für REINHARDT KMFT interface
- Ideally designed for MA xx13 test fixtures
- Quick, easy installation on the back of the test fixture
- Reliable connection from test fixture to system interface

Application

The interface frame (SSA) is used for reliable connection of the interface (SST) to the test fixture.

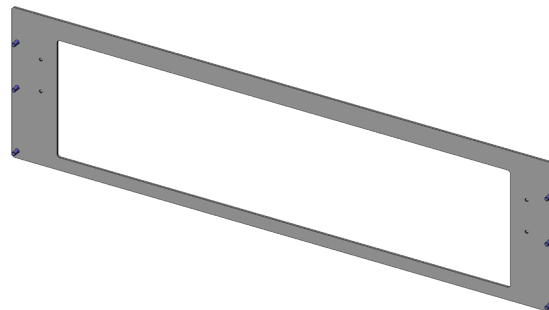

General data

Product group:

Series:

Type:

Version:

Accessory type:

Scope of delivery:

Width:

Height:

Weight:

Min. temperature:

Max. temperature:

RoHS-compliant:

Housing

SSA-MAxxxx

KMFT (Reinhardt)

MA xx13

Additional function

Unassembled

4 mm [.157 in]

165 mm [6.49 in]

0.35 kg [.771 lbs]

10 °C [50 °F]

60 °C [140 °F]

Yes

Compatible with

Manual test fixtures (MA):

Accessories:

MA xx13

SST-KMFT

Technical data

Length:

600 mm [23.6 in]

Outer dimensionS (WxDxH):

600 x 4 x 165 mm [23.6 x .157 x 6.49 in]

INGUN Prüfmittelbau GmbH

Max-Stromeyer-Straße 162

78467, Constance, Germany

Phone +49 7531 8105-0

Customer hotline +49 7531 8105-888

Fax +49 7531 8105-65

info@ingun.com



Prices and delivery times on request.
Technical changes reserved. 05/26_GB

Learn more about
Test fixture kits

