

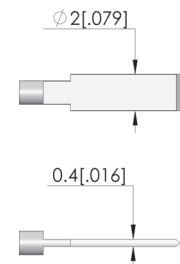

GO TO PRODUCT

## Prüfung von Kabelschuhen

zur Überprüfung von Steckverbindern mit geometrisch eindeutig ausgerichteten Kontaktterminals

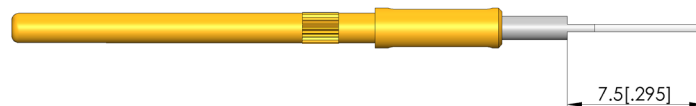
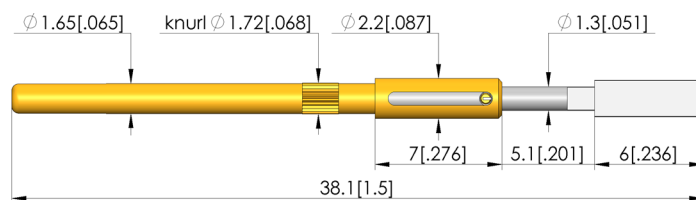
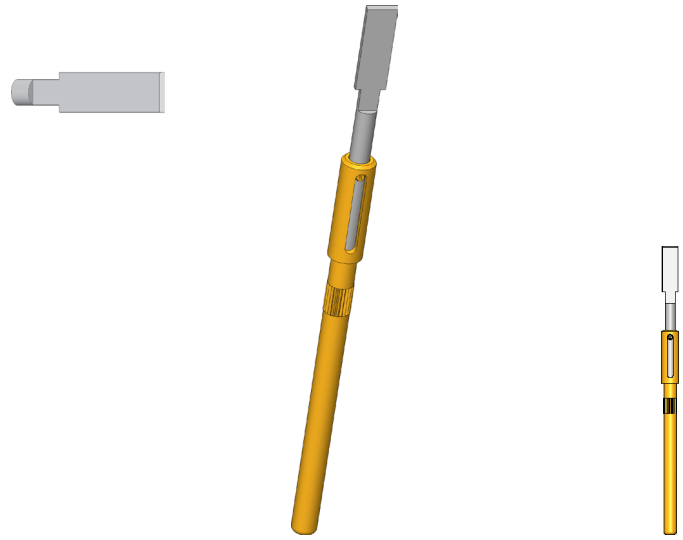

1:1

# Test Probe

## GKS-710 220 040 R 5007

Item GKS-710-0038



GO TO PRODUCT

# ingun®

Partner for Future Technology

### General data

Product group:	xxx
Sub-product group:	Non-rotating test probes
Series:	GKS-710
Grid:	2.54 mm [100 mil]
Contacting from:	Female connector
Magnetic:	Yes
Installation type:	Plug-in
Quick-exchange system:	No
Adjustable installation height:	No
Non-rotating:	Yes
Min. temperature:	-40 °C [-40 °F]
Max. temperature:	80 °C [176 °F]
RoHS-compliant:	Yes

### Tip style data

Tip style:	20 spade, flat, bevelled, self-cleaning
Tip diameter:	2 mm [.078 in]
Tip style surface:	R rhodium
Tip style material:	2 steel
Spade width:	0.4 mm [.015 in]
Spade length:	7.5 mm [.295 in]

### Electrical data

Current load capacity / rated current:	5 A
Typical resistance (RI):	30 mOhm

### Mechanical data

Total length:	38.1 mm [1.5 in]
Barrel diameter:	1.65 mm [.064 in]
Maximum stroke:	5 mm [.196 in]
Spring pre-load:	1.77 N [6.36 ozf]
Collar height:	07
Spring force at working stroke:	5 N [17.9 ozf]
Recommended working stroke:	4 mm [.157 in]

### INGUN Prüfmittelbau GmbH

Max-Stromeyer-Straße 162  
78467, Constance, Germany  
Phone +49 7531 8105-0  
Customer hotline +49 7531 8105-888  
Fax +49 7531 8105-65  
info@ingun.com



Prices and delivery times on request.  
Technical changes reserved. 06/26\_GB