

# Receptacle

## KS-112 35

Item KS-11235



GO TO PRODUCT

**ingun**<sup>®</sup>

Partner for Future Technology

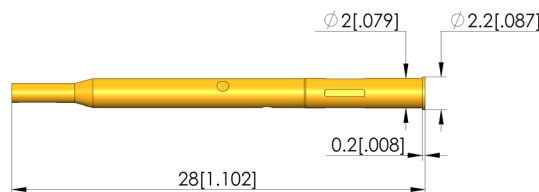
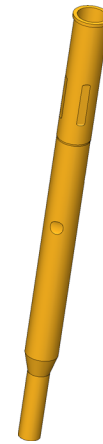

### General data

Product group: Receptacles (KS)  
Series: KS-112  
Sub-series: KS-112 press-in version  
Type of receptacle connection: Plug / open  
Press ring: No  
Surface area: Gold  
Collar diameter: 2.2 mm [.086 in]  
Collar height: 0.2 mm [.007 in]  
Knurl: No  
Vacuum-tight: No  
RoHS-compliant: Yes

### Mechanical data

Total length: 28 mm [1.1 in]  
Outer diameter: 2 mm [.078 in]

### Mounting hole

Mounting hole in CEM1: 1.98 - 2 mm [.077 - .078 in]  
Mounting hole in FR4: 1.99 - 2.01 mm [.078 - .079 in]

### INGUN Prüfmittelbau GmbH

Max-Stromeyer-Straße 162  
78467, Constance, Germany  
Phone +49 7531 8105-0  
Customer hotline +49 7531 8105-888  
Fax +49 7531 8105-65  
info@ingun.com



Prices and delivery times on request.  
Technical changes reserved. 06/26\_GB

Learn more about  
Test probes

