

S-Line assembly kit, bottom

SBU-540-300-ATSMA14

Item 113329



GO TO PRODUCT

ingun[®]

Partner for Future Technology

- Precise, reliable contacting in small grids
- Quick, easy installation
- Extensive, detailed customisation guidelines
- Plate material is deflection-resistant FR4

NEW

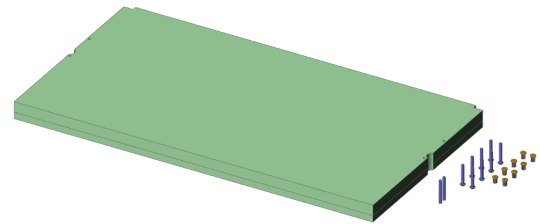

General data

Product group:
Subseries:
Series:
Version:
Scope of delivery:
Dual-stage contacting:
Weight:
Min. temperature:
Max. temperature:
RoHS-compliant:

ATS MA upgrade kits
ATS MAxx
SBU
S-Line standard
Unassembled
Yes
8.32 kg [18.3 lbs]
10 °C [50 °F]
60 °C [140 °F]
Yes

Compatible with

Exchangeable kit(s) (ATS):
Manual test fixtures (MA):

ATS MA14
MA 2014

Technical data

Useable area (WxD): 532 x 300 mm [20.9 x 11.8 in]
Outer dimensionS (WxDxH): 546 x 300 x 26 mm [21.4 x 11.8 x 1.02 in]

INGUN Prüfmittelbau GmbH

Max-Stromeyer-Straße 162
78467, Constance, Germany
Phone +49 7531 8105-0
Customer hotline +49 7531 8105-888
Fax +49 7531 8105-65
info@ingun.com



Prices and delivery times on request.
Technical changes reserved. 06/26_GB

Learn more about
MA exchangeable kits

