

# Gas pressure spring

## GDF-145-40-100N-A6-A6

Item 2504



GO TO PRODUCT

**ingun**<sup>®</sup>

Partner for Future Technology

- Trusted gas springs from the market leader
- Store with the piston rod facing downwards

### Note:

The gas springs must be stored with the piston rod pointing downwards so that the seal remains moistened from the inside. It makes no difference whether the piston of the gas spring is extended (unloaded) or retracted (loaded).

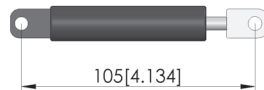
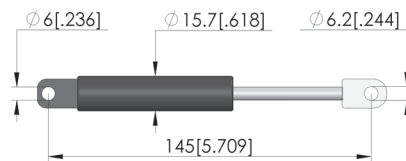

### General data

Product group:  
Series:  
Type:  
Version:  
Accessory type:  
Min. temperature:  
Max. temperature:  
RoHS-compliant:

Gas springs  
GDF  
Gas spring  
Standard, attenuated  
Spare parts  
10 °C [50 °F]  
60 °C [140 °F]  
Yes

### Technical data

Stroke:  
Force:  
Length:  
Gas pressure spring length, home position:  
Plunger length, home position:  
Installation 1 diameter:  
Installation 2 diameter:

40 mm [1.57 in]  
100 N [359 ozf]  
145 mm [5.7 in]  
105 mm [4.13 in]  
49 mm [1.92 in]  
6 mm [0.236 in]  
6.2 mm [0.244 in]

# Gas pressure spring **GDF-145-40-100N-A6-A6**

Item 2504



**ingun**<sup>®</sup>

Partner for Future Technology



## **INGUN Prüfmittelbau GmbH**

Max-Stromeyer-Straße 162  
78467, Constance, Germany  
Phone +49 7531 8105-0  
Customer hotline +49 7531 8105-888  
Fax +49 7531 8105-65  
info@ingun.com



Prices and delivery times on request.  
Technical changes reserved. 06/26\_GB