

High-current test probe

HSS-120 302 230 A 2205

Item HSS-120-0009



GO TO PRODUCT

ingun[®]

Partner for Future Technology

- Trusted, robust high-current probes, optimally sized for current load capacity ratio
- Low-resistance contact probe with R_i typical < 10 mΩ
- For use in function and burn-in tests
- Large selection of tip styles and spring forces for optimum contact with DUT
- Optimum adjustment of the stroke ratios in the test fixture: The test probe collar is available in different heights, which, in combination with the receptacles, allows a range of installation heights

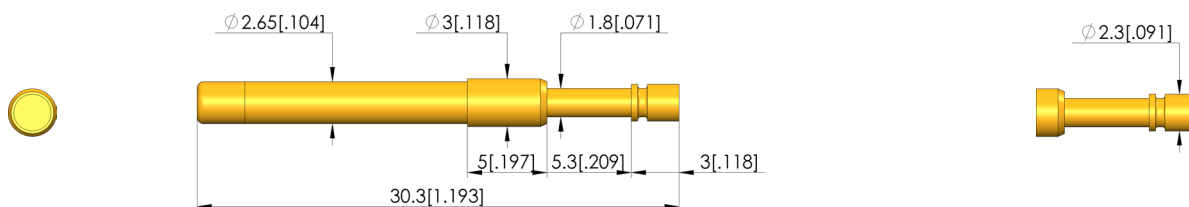
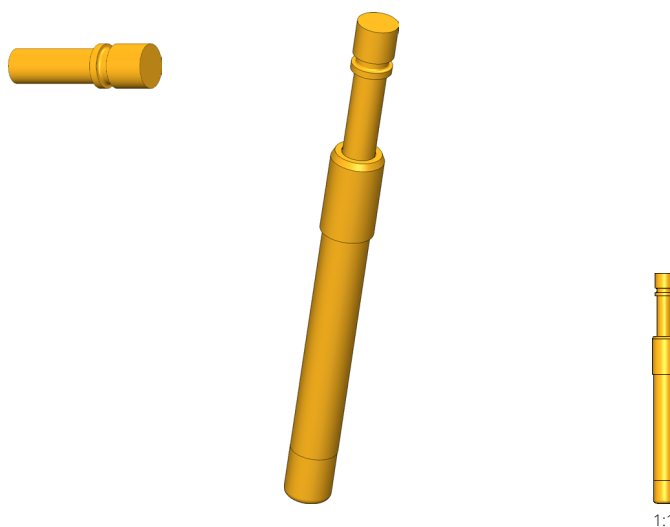

General data

Product group: Standard HSS (press-in)
 Sub-product group: Standard HSS (press-in)
 Series: HSS-120
 Grid: 4 mm [157 mil]
 Contacting from: Post
 Magnetic: Yes
 Installation type: Plug-in
 Quick-exchange system: Yes
 Adjustable installation height: No
 Non-rotating: No
 Compatible receptacle(s): KS-113
 Min. temperature: -100 °C [-148 °F]
 Max. temperature: 200 °C [392 °F]
 RoHS-compliant: Yes

Standard HSS (press-in)
 Standard HSS (press-in)
 HSS-120
 4 mm [157 mil]
 Post
 Yes
 Plug-in
 Yes
 No
 No
 KS-113
 -100 °C [-148 °F]
 200 °C [392 °F]
 Yes

Tip style data

Tip style: 02 flat
 Tip diameter: 2.3 mm [.09 in]
 Tip style surface: A gold
 Tip style material: 3 CuBe

Electrical data

Current load capacity / rated current: 30 A
 Typical resistance (R_i): 10 mΩ

Mechanical data

Total length: 30.3 mm [1.19 in]
 Barrel diameter: 2.65 mm [.104 in]
 Maximum stroke: 5.3 mm [.208 in]
 Spring pre-load: 0.58 N [2.08 ozf]
 Collar height: 05
 Spring force at working stroke: 2.25 N [8.09 ozf]
 Recommended working stroke: 4 mm [.157 in]

HIGH-CURRENT TEST PROBES

High-current test probe HSS-120 302 230 A 2205

Item HSS-120-0009



GO TO PRODUCT

ingun[®]

Partner for Future Technology

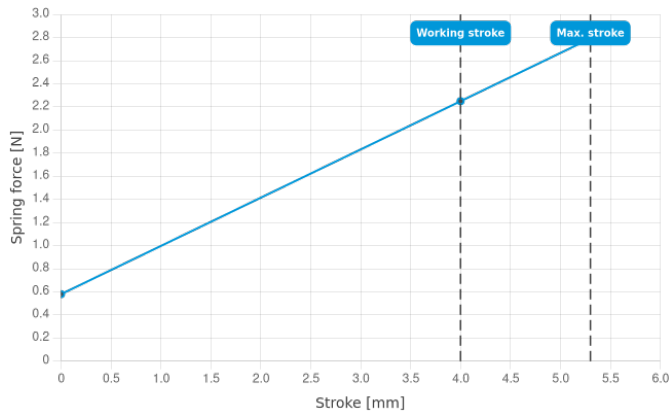

INGUN Prüfmittelbau GmbH

Max-Stromeyer-Straße 162
78467, Constance, Germany
Phone +49 7531 8105-0
Customer hotline +49 7531 8105-888
Fax +49 7531 8105-65
info@ingun.com



Prices and delivery times on request.
Technical changes reserved. 06/26_GB

Learn more about
High-current test probes



HIGH-CURRENT TEST PROBES

ingun.com