

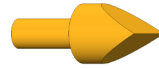

## Durchgangsprüfung

Zur Überprüfung von möglichen offenen Verbindungen, Kurzschlüssen und Fehlverdrahtungen



1:1

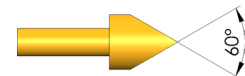
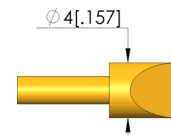
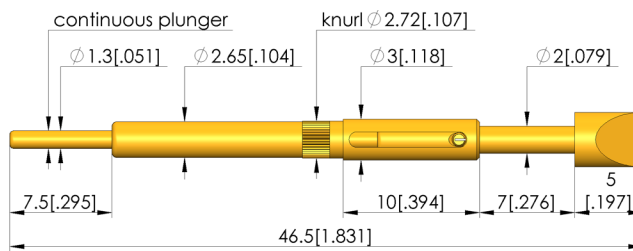

### General data

Product group:	xxx
Sub-product group:	Non-rotating test probes
Series:	GKS-714
Grid:	5.08 mm [200 mil]
Contacting from:	Female connector
Magnetic:	Yes
Installation type:	Plug-in
Quick-exchange system:	Yes
Type of test probe connection:	Plug
Adjustable installation height:	No
Non-rotating:	Yes
Continuous plunger:	$\phi 1,3 \times 7,5$
Compatible connector(s):	SE-503
Compatible receptacle(s):	KS-714
Min. temperature:	-40 °C [-40 °F]
Max. temperature:	80 °C [176 °F]
RoHS-compliant:	Yes

### Tip style data

Tip style:	23 chisel
Tip diameter:	4 mm [.157 in]
Tip style surface:	A gold
Tip style material:	2 steel

### Electrical data

Current load capacity / rated current:	8 A
Typical resistance (Ri):	30 mOhm

### Mechanical data

Total length:	46.5 mm [1.83 in]
Barrel diameter:	2.65 mm [.104 in]
Maximum stroke:	7 mm [.275 in]
Spring pre-load:	0.38 N [1.36 ozf]
Collar height:	10
Spring force at working stroke:	1.5 N [5.39 ozf]
Recommended working stroke:	6 mm [.236 in]

Test Probe

**GKS-714 223 400 A 1510**

Item GKS-714-0016



GO TO PRODUCT

**ingun**<sup>®</sup>

Partner for Future Technology

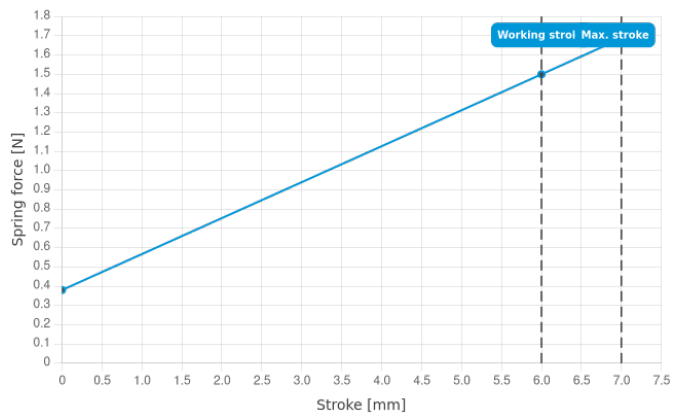

**INGUN Prüfmittelbau GmbH**

Max-Stromeyer-Straße 162  
78467, Constance, Germany  
Phone +49 7531 8105-0  
Customer hotline +49 7531 8105-888  
Fax +49 7531 8105-65  
info@ingun.com



Prices and delivery times on request.  
Technical changes reserved. 06/26\_GB