

Electric stroke counter

EHZ-08-R-32-HE

Item 34865



GO TO PRODUCT

ingun[®]

Partner for Future Technology

- Compact built-in counter
- 8-segment LCD display
- Integrated battery
- Manual reset
- Count frequency: 30 Hz
- Installation dimensions (WxDxH): 44.8 x 31.2 x 22 mm

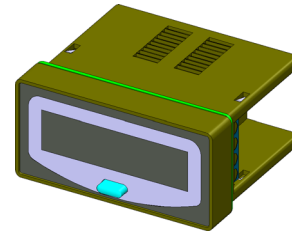

Application

Stroke counters are intended for installation in test fixtures and are used as batch counters to count the number of contact strokes.

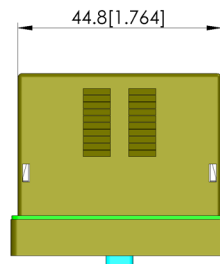
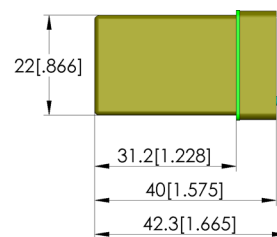
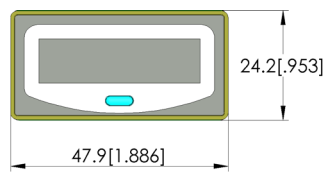

General data

Product group:	Electric accessory
Series:	EHZ
Type:	Mechanical counter - Hengstler
Version:	8-digit LCD, manual reset
Accessory type:	Customising accessories
Colour:	Dark grey
Width:	42.3 mm [1.66 in]
Height:	24.2 mm [.952 in]
Weight:	0.02 kg [.044 lbs]
Min. temperature:	-10 °C [14 °F]
Max. temperature:	50 °C [122 °F]
RoHS-compliant:	Yes

Compatible with

Manual test fixtures (MA):	MA xxxx
Pneumatic test fixtures (PA):	PAZ 400
Vacuum test fixtures (VA):	VA xxxx

Technical data

Connection:	Screw terminal
Length:	48 mm [1.88 in]
Outer dimensionS (WxDxH):	48 x 42.3 x 24.2 mm [1.88 x 1.66 x .952 in]

INGUN Prüfmittelbau GmbH

Max-Stromeyer-Straße 162
78467, Constance, Germany
Phone +49 7531 8105-0
Customer hotline +49 7531 8105-888
Fax +49 7531 8105-65
info@ingun.com



Prices and delivery times on request.
Technical changes reserved. 06/26_GB