

# Locking interface

## FB-VER-F-M-PYLON12

Item 116234



GO TO PRODUCT

**ingun**<sup>®</sup>

Partner for Future Technology

- Dock onto Pylon receiver without lifting the test fixture via the locking latch
- Reliable locking of the closure mechanism
- Manual operation of the locking slide

### Application

The functional unit is used to dock test fixtures with a Pylon interface to the Pylon receiver without having to lift the test fixture via the receiver's locking latch. The locking mechanism is opened and closed manually by simply actuating the locking slide.



### General data

Product group:	Locking units
Series:	FB-RC
Type:	Locking unit for interface
Version:	PYLON-12 (manual)
Accessory type:	Additional function
Scope of delivery:	2 x locking unit, pre-installed
Material:	1.0037, galvanised
Width:	29 mm [1.14 in]
Height:	60 mm [2.36 in]
Weight:	0.45 kg [.992 lbs]
Min. temperature:	10 °C [50 °F]
Max. temperature:	60 °C [140 °F]
RoHS-compliant:	Yes

### Compatible with

Accessories: SST-PYLON-12

### Technical data

Stroke:	16 mm [.629 in]
Installation:	Bore D = 3.2 mm
Length:	110 mm [4.33 in]
Outer dimensionS (WxDxH):	110 x 29 x 60 mm [4.33 x 1.14 x 2.36 in]

# Locking interface FB-VER-F-M-PYLON12

Item 116234



GO TO PRODUCT

**ingun**<sup>®</sup>

Partner for Future Technology

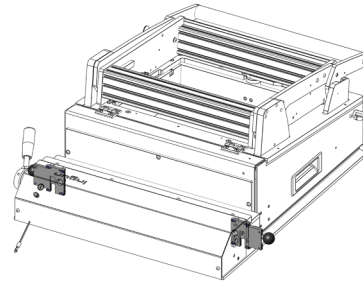
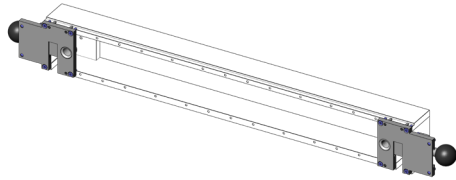

## Accessories

Part no.	Designation	Version
109145	SST-PYLON-12	Pylon interface
32162	RC-PYLON-12-V2	Pylon receiver

## INGUN Prüfmittelbau GmbH

Max-Stromeyer-Straße 162  
78467, Constance, Germany  
Phone +49 7531 8105-0  
Customer hotline +49 7531 8105-888  
Fax +49 7531 8105-65  
info@ingun.com



Prices and delivery times on request.  
Technical changes reserved. 05/26\_GB

Learn more about  
Test fixture kits

