

Battery contacting probe

BCP-690 360 500 A 10002

Item BCP-690-0001



GO TO PRODUCT

ingun[®]

Partner for Future Technology

- Ideal for end-of-line validation of cells and batteries - designed specifically for applications such as OCV, AC-IR, Insulation test and Hi-Pot measurement
- Maximum process reliability – Large stroke range compensates cell tolerances and process variations, ensuring a stable contact
- Designed for continuous operation ($\geq 500k$ cycles) - Minimizes downtime and maintenance – ideal for high-volume battery cell production
- Stable, low contact resistance when contacting through oxide layers - due to aggressive and serrated tip and continuous plunger design
- Easy Installation - simple assembly because of the push-in type design
- Maximum integration flexibility - Multiple connection options (plug-in, threaded, soldering) enable seamless integration into any test setup

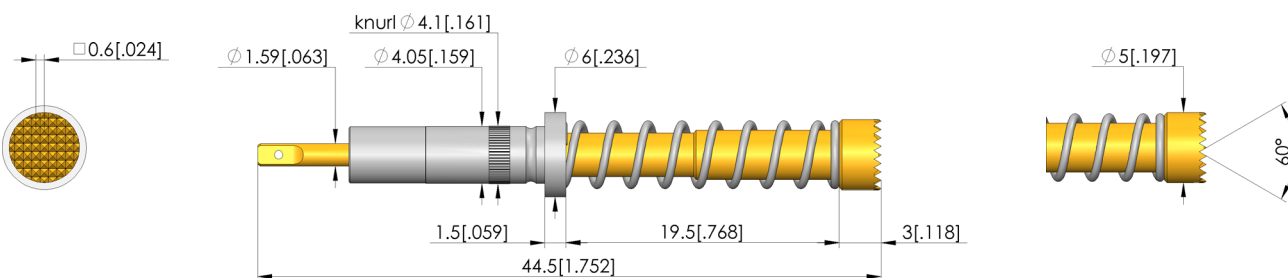
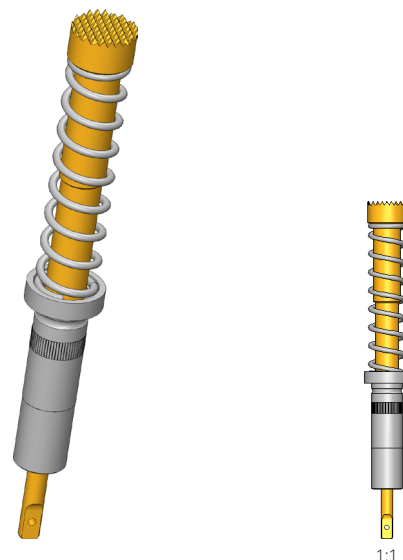

General data

Product group:	Battery Contacting
Sub-product group:	Standard BCP (press-in)
Series:	BCP-690
Application rec.:	
Grid:	7 mm [275 mil]
DUT / contact:	
Magnetic:	Yes
Installation type:	Press-in
Quick-exchange system:	No
Type of test probe connection:	Plug
Adjustable installation height:	No
Non-rotating:	No
Compatible connector(s):	SE-AWG20-0002
Min. temperature:	-100 °C [-148 °F]
Max. temperature:	200 °C [392 °F]
RoHS-compliant:	Yes

Electrical data

Current load capacity / rated current:	60 A
Rated current on copper @ $\Delta T \leq 20$ K:	30 A
Rated current on copper @ $\Delta T \leq 60$ K:	60 A
Rated current on aluminium @ $\Delta T \leq 20$ K:	20 A
Rated current on aluminium @ $\Delta T \leq 60$ K:	45 A
Typical resistance (Ri):	2 mOhm

Mechanical data

Total length:	44.5 mm [1.75 in]
Barrel diameter:	4.1 mm [1.61 in]
Maximum stroke:	10 mm [3.93 in]
Spring pre-load:	3.85 N [13.8 ozf]
Collar height:	02
Spring force at working stroke:	10 N [35.9 ozf]
Recommended working stroke:	5 mm [1.96 in]
Mounting hole in probe plate (KTP):	4.07 - 4.09 mm [1.6 - .161 in]

Tip style data

Tip style:	60 serrated, small grid
Tip diameter:	5 mm [1.96 in]
Tip style surface:	A gold
Tip style material:	3 CuBe

Battery contacting probe

BCP-690 360 500 A 10002

Item BCP-690-0001



ingun[®]

Partner for Future Technology

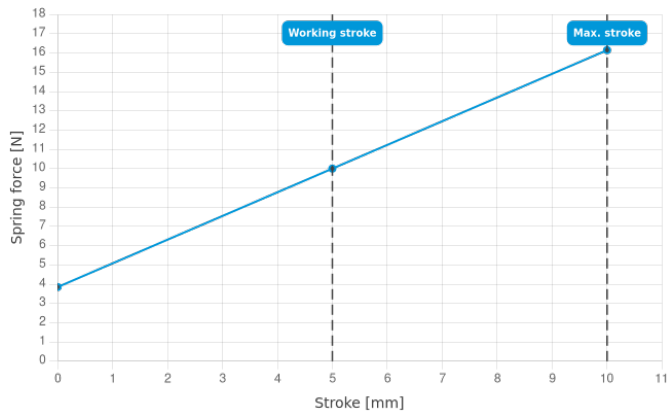

Tool

Part no. EN	Designation	Tip version EN
SW-0016	SW-BCP-690	Insertion Tool

Cable plug assemblies

Part no. EN	Designation	Tip version EN
SE-AWG20-0002	SE-AWG20-2-BU01660-100	cable assembly

INGUN Prüfmittelbau GmbH

Max-Stromeyer-Straße 162
78467, Constance, Germany
Phone +49 7531 8105-0
Customer hotline +49 7531 8105-888
Fax +49 7531 8105-65
info@ingun.com



Prices and delivery times on request.
Technical changes reserved. 06/26_GB

Learn more about
Test probes

