



GO TO PRODUCT

## Durchgangsprüfung

Zur Überprüfung von möglichen offenen Verbindungen, Kurzschlüssen und Fehlverdrahtungen

- Robust test probes with distinctive collar (stop) on the barrel
- Optimum adjustment of the stroke ratios in the test fixture: The collar is available in different heights, which, in combination with the receptacles, allows a range of installation heights
- Version with central beading ensure low wobble for contacting small test points
- Stainless steel versions for temperatures from -100 °C up to +200 °C available

### INGUN SELECTION

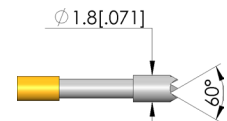
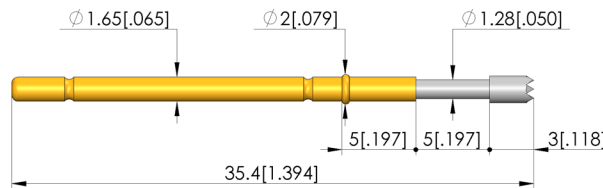
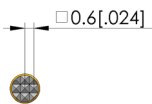
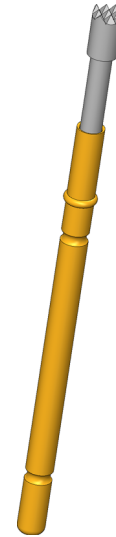
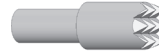

### General data

Product group:  
Sub-product group:  
Series:  
Grid:  
Contacting from:  
Magnetic:  
Installation type:  
Quick-exchange system:  
Adjustable installation height:  
Non-rotating:  
Compatible receptacle(s):  
Min. temperature:  
Max. temperature:  
RoHS-compliant:

ICT / FCT (in-circuit test and function test)  
Metric standard  
GKS-912  
2.54 mm [100 mil]  
Post  
Yes  
Plug-in  
Yes  
No  
No  
KS-112  
-40 °C [-40 °F]  
80 °C [176 °F]  
Yes

### Tip style data

Tip style:  
Tip diameter:  
Tip style surface:  
Tip style material:

06 serrated  
1.8 mm [.07 in]  
R rhodium  
3 CuBe

### Electrical data

Current load capacity / rated current:  
Typical resistance (Ri):

8 A  
20 mOhm

### Mechanical data

Total length:  
Barrel diameter:  
Maximum stroke:  
Spring pre-load:  
Collar height:  
Spring force at working stroke:  
Recommended working stroke:

35.4 mm [1.39 in]  
1.66 mm [.065 in]  
5 mm [.196 in]  
0.93 N [3.34 ozf]  
05  
3 N [10.7 ozf]  
4 mm [.157 in]

# Test Probe

## GKS-912 306 180 R 3005

Item GKS-912-0591



**ingun**<sup>®</sup>

Partner for Future Technology

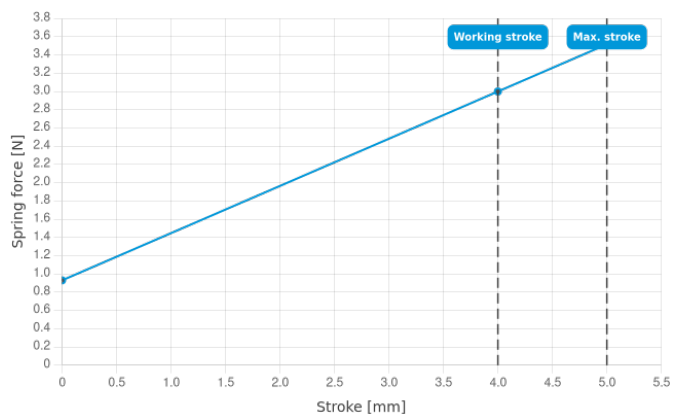

### INGUN Prüfmittelbau GmbH

Max-Stromeyer-Straße 162  
78467, Constance, Germany  
Phone +49 7531 8105-0  
Customer hotline +49 7531 8105-888  
Fax +49 7531 8105-65  
info@ingun.com



Prices and delivery times on request.  
Technical changes reserved. 06/26\_GB

Learn more about  
ICT/FCT Test probes



ingun.com

ICT/FCT TEST PROBES