

# Receptacle KS-112 30 M-R

Item KS-11230M-R



GO TO PRODUCT

**ingun**<sup>®</sup>

Partner for Future Technology

## Kontaktsteckhülsen

Mit Gewinde zum Einpressen in das Trägermaterial

INGUN SELECTION

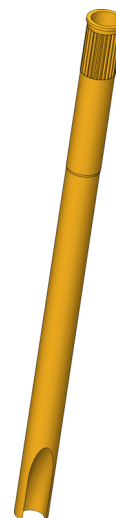

1:1

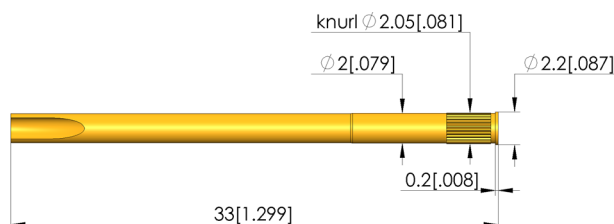

### General data

Product group:  
Series:  
Sub-series:  
Type of receptacle connection:  
Press ring:  
Surface area:  
Collar diameter:  
Collar height:  
Knurl:  
Vacuum-tight:  
RoHS-compliant:

Receptacles (KS)  
KS-112  
KS-112 M screw-in version  
Solder  
No  
Gold  
2.2 mm [.086 in]  
0.2 mm [.007 in]  
Yes  
No  
Yes

### Mechanical data

Total length: 33 mm [1.29 in]  
Outer diameter: 2 mm [.078 in]

### Mounting hole

Mounting hole in CEM1: 2 - 2.02 mm [.078 - .079 in]  
Mounting hole in FR4: 2 - 2.02 mm [.078 - .079 in]

### INGUN Prüfmittelbau GmbH

Max-Stromeyer-Straße 162  
78467, Constance, Germany  
Phone +49 7531 8105-0  
Customer hotline +49 7531 8105-888  
Fax +49 7531 8105-65  
info@ingun.com



Prices and delivery times on request.  
Technical changes reserved. 06/26\_GB

Learn more about  
Test probes

