

S-Line assembly kit, bottom

SBU-285-230-WL-ATSMA12

Item 113151



GO TO PRODUCT

ingun[®]

Partner for Future Technology

- Precise, reliable contacting in small grids
- Quick, easy installation
- Extensive, detailed customisation guidelines
- Plate material is deflection-resistant FR4

NEW

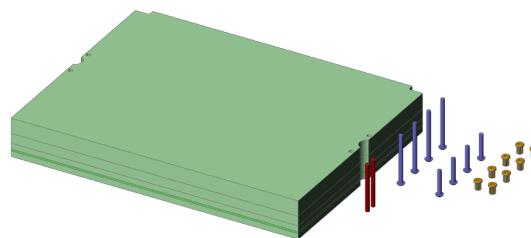

General data

Product group:

Subseries:

Series:

Version:

Scope of delivery:

Dual-stage contacting:

Weight:

Min. temperature:

Max. temperature:

RoHS-compliant:

ATS MA upgrade kits

ATS MAxx

SBU

S-Line wireless

Unassembled

Yes

5.29 kg [11.6 lbs]

10 °C [50 °F]

60 °C [140 °F]

Yes

Compatible with

Exchangeable kit(s) (ATS):

Manual test fixtures (MA):

ATS MA12

MA 2012

Technical data

Useable area (WxD):

285 x 230 mm [11.2 x 9.05 in]

Outer dimensionS (WxDxH):

298 x 230 x 40 mm [11.7 x 9.05 x 1.57 in]

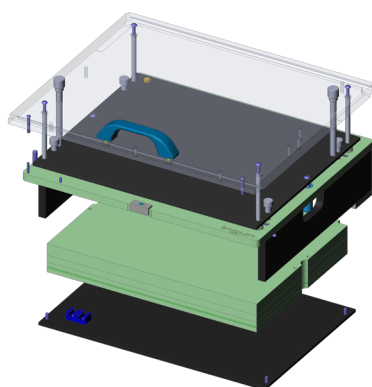

INGUN Prüfmittelbau GmbH

Max-Stromeyer-Straße 162

78467, Constance, Germany

Phone +49 7531 8105-0

Customer hotline +49 7531 8105-888

Fax +49 7531 8105-65

info@ingun.com



Prices and delivery times on request.
Technical changes reserved. 06/26_GB

Learn more about
MA exchangeable kits



EXCHANGEABLE KITS

ingun.com