

High-current test probe

HSS-150 319 400 A 3002

Item HSS-150-0118



GO TO PRODUCT

ingun[®]

Partner for Future Technology

- Trusted, robust high-current probes, optimally sized for current load capacity ratio
- Low-resistance contact probe with R_i typical < 10 m Ω
- For use in function and burn-in tests
- Large selection of tip styles and spring forces for optimum contact with DUT
- Optimum adjustment of the stroke ratios in the test fixture: The test probe collar is available in different heights, which, in combination with the receptacles, allows a range of installation heights

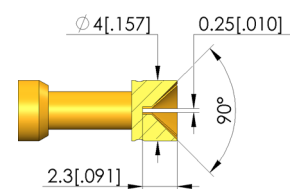
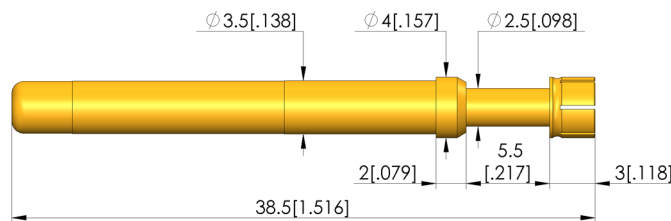
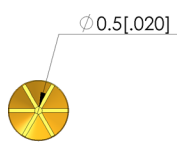
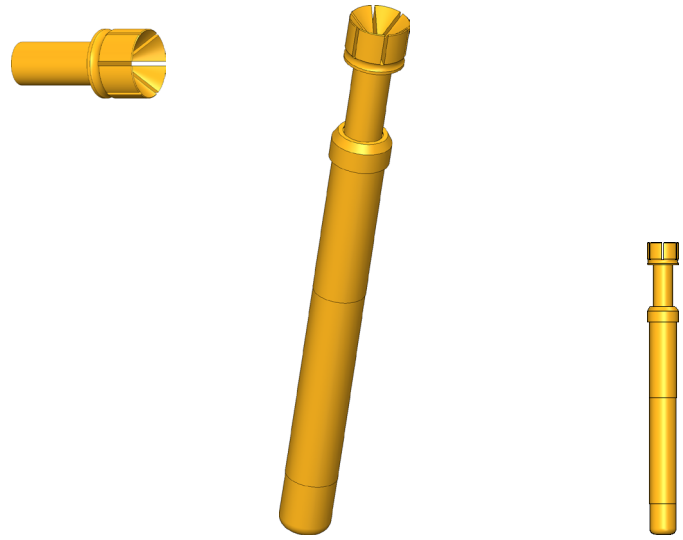

General data

Product group:	Standard HSS (press-in)
Sub-product group:	Standard HSS (press-in)
Series:	HSS-150
Grid:	5.08 mm [200 mil]
Contacting from:	Post
Magnetic:	Yes
Installation type:	Plug-in
Quick-exchange system:	Yes
Adjustable installation height:	No
Non-rotating:	No
Compatible receptacle(s):	KS-150
Min. temperature:	-100 °C [-148 °F]
Max. temperature:	200 °C [392 °F]
RoHS-compliant:	Yes

Tip style data

Tip style:	19 90° inverse cone, slotted, self cleaning
Tip diameter:	4 mm [.157 in]
Tip style surface:	A gold
Tip style material:	3 CuBe

Electrical data

Current load capacity / rated current:	50 A
Typical resistance (R_i):	10 mOhm

Mechanical data

Total length:	38.5 mm [1.51 in]
Barrel diameter:	3.5 mm [.137 in]
Maximum stroke:	5.5 mm [.216 in]
Spring pre-load:	1.31 N [4.71 ozf]
Collar height:	02
Spring force at working stroke:	3 N [10.7 ozf]
Recommended working stroke:	4.4 mm [1.73 in]

HIGH-CURRENT TEST PROBES

High-current test probe HSS-150 319 400 A 3002

Item HSS-150-0118



GO TO PRODUCT

ingun[®]

Partner for Future Technology

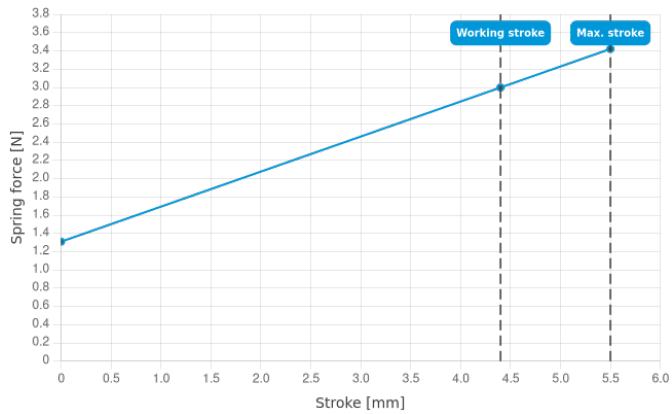

INGUN Prüfmittelbau GmbH

Max-Stromeyer-Straße 162
78467, Constance, Germany
Phone +49 7531 8105-0
Customer hotline +49 7531 8105-888
Fax +49 7531 8105-65
info@ingun.com



Prices and delivery times on request.
Technical changes reserved. 05/26_GB

Learn more about
High-current test probes



HIGH-CURRENT TEST PROBES

ingun.com