

# Dual-stage locking unit

## FB-2VM-MA3xxx

Item 106841



GO TO PRODUCT

ingun®

Partner for Future Technology

- For 1-stage or 2-stage contacting without self-opening unit
- Mechanical limit of contacting stage
- Quick, easy installation by replacing the rear bearing block
- Adjustable screw to select ICT or ICT/FCT operating mode.
- Optionally available proximity switch to detect FCT position

### Application

Using the mechanical dual-stage locking units (FB-2VM) for MA xxxxx test fixtures, both single-stage (ICT) and dual-stage contacting (ICT/FCT combined) can be reliably performed. When using the version without electric motor, tests are performed without a self-opening unit, whereas the version with an electric motor performs tests with a self-opening unit. Installation is quick and easy; only the rear bearing block on the left side has to be replaced. Before operation of upgraded MA xxxxx test fixtures begins, the adjusting screw on the outside of the bearing block should be adjusted to select the operating mode: either ICT or ICT/FCT. Both contacting stages have mechanical limits and are not statically locked.

### Delivery

The functional unit is supplied pre-assembled, without inductive proximity switch.

### General data

Product group:	Functional units
Series:	FB-MAxxxx
Type:	Dual-stage limit
Version:	Mechanical without electric motor
Accessory type:	Additional function
Scope of delivery:	Pre-assembled
Material:	3.3547, hard-coated
Width:	15 mm [.59 in]
Height:	101 mm [3.97 in]
Weight:	0.45 kg [.992 lbs]
Min. temperature:	10 °C [50 °F]
Max. temperature:	60 °C [140 °F]
RoHS-compliant:	Yes

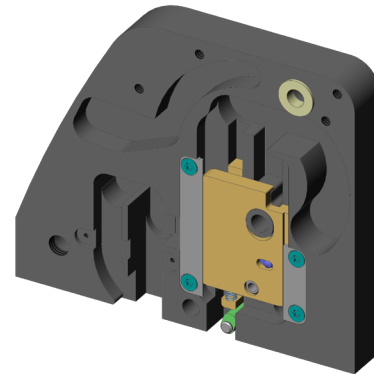

### Note:

Before operation of upgraded MA xxxxx test fixtures begins, the adjusting screw on the outside of the bearing block should be adjusted to select the operating mode - either ICT, to perform single-stage contacting, or ICT/FCT, to perform dual-stage contacting.

### Note:

Operating voltage electric motor in the range of 5 V to max. 36 V DC.

### Compatible with

Manual test fixtures (MA):	MA 3xxx
For dual-stage contacting:	Yes

### Technical data

Installation:	Thread M5
Length:	118 mm [4.64 in]
Outer dimensionS (WxDxH):	15 x 118 x 101 mm [.59 x 4.64 x 3.97 in]

FUNCTIONAL UNIT

# Dual-stage locking unit

## FB-2VM-MA3xxx

Item 106841



GO TO PRODUCT

**ingun**<sup>®</sup>

Partner for Future Technology

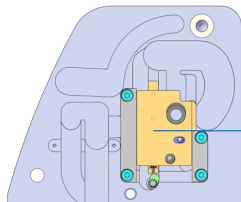

Mechanical 2-stage locking unit without electric motor, for tests without self-opening unit

Locking mechanism

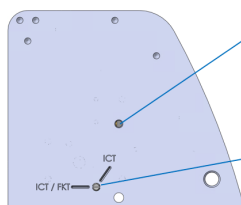
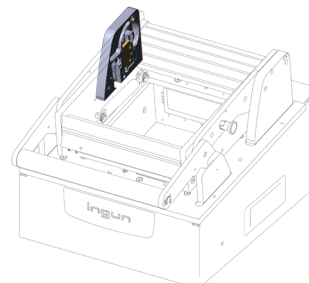

Position for optionally available inductive proximity switch

Adjusting screw to select operating mode:

- ICT: 1-stage contacting
- ICT/FCT: 2-stage contacting

### Accessories

Part no.	Designation	Version
Accessories		
112801	FB-2VM-MOT-MAxxxx	Upgrade kit: electric motor without electronics
111185	FB-STE-2VM-MAxxxx	Upgrade kit: electronics
111136	ENS-I-M04-S-0,6-10-30V-K2,0	Inductive proximity switch, PNP closer; switching distance $\leq 0.6$ mm; D = M4; 10-30 VDC; cable ~2 m

### INGUN Prüfmittelbau GmbH

Max-Stromeyer-Straße 162  
78467, Constance, Germany  
Phone +49 7531 8105-0  
Customer hotline +49 7531 8105-888  
Fax +49 7531 8105-65  
info@ingun.com



Prices and delivery times on request.  
Technical changes reserved. 05/26\_GB

Learn more about  
MA functional units



FUNCTIONAL UNIT

ingun.com