

Board marker probe

ME-E-R2,0-12-080-S12V

Item 38371



GO TO PRODUCT

ingun[®]

Partner for Future Technology

- Compact, robust design
- Precise, adjustable positioning
- Permanent marking of various materials
- Outstanding service life, highly resistant to wear
- Electric drive system

INGUN SELECTION

Application

The new ME-E board marker probe is used for reliable marking of tested electronic assemblies. It is installed in a test fixture or exchangeable kit, takes up little space, and can be precisely adjusted.

Function

The spring-loaded marking engraver is pressed against the surface of the PCB during the test. The marking unit is supplied with current in the contacted state. The rotary movement generated by the current marks the PCB permanently.

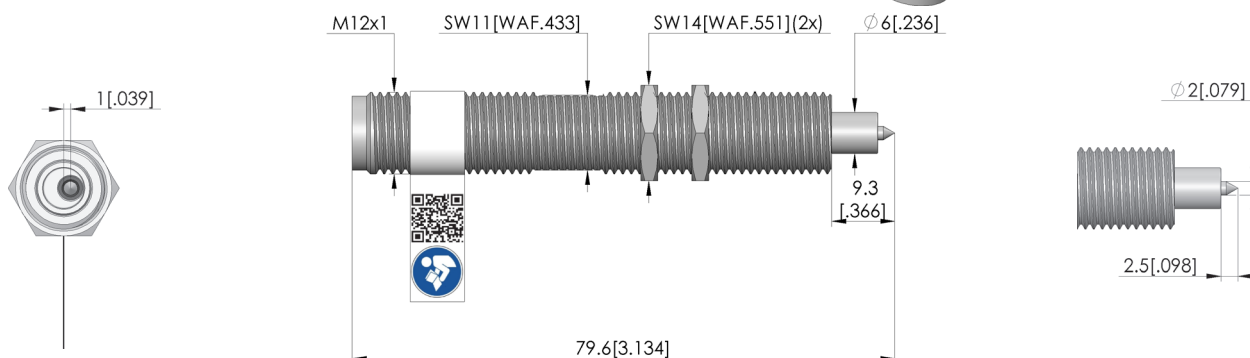
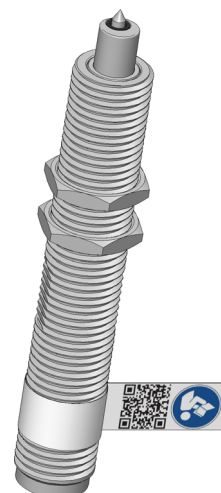

General data

Product group: Board marker probes (ME)
 Series: ME-E
 Version: Electrical
 Accessory type: Customising accessories
 Outer dimensions (TxL): 12 x 80 mm [0.472 x 3.14 in]
 Outer thread: M12 x 1
 Lock nut width across flats: 14 mm [0.551 in]
 Marking type: Circle
 Approx. marking ϕ : 2 mm [0.078 in]
 Surface material: Hard / soft
 Weight: 0.05 kg [0.11 lbs]
 Min. temperature: -20 °C [-4 °F]
 Max. temperature: 65 °C [149 °F]
 RoHS-compliant: Yes

Compatible with

Manual test fixtures (MA): MA 20xx
 Vacuum test fixtures (VA): VA xxxx
 MA exchangeable kits (ATS MA):
 VA exchangeable kits (ATS VA): ATS VINxxx
 PA exchangeable kits (ATS PA): PAZxxx

Technical data

Recommended working stroke: 1.5 mm [0.059 in]
 Recommended marking impulse: 1 s
 Maximum stroke (ME): 2 mm [0.078 in]
 Approx. compression at working stroke: 3 N [10.7 ozf]
 Marking tip: Scratching engraver
 Engraver material: Solid carbide
 Approx. engraver hardness: 1600 HV
 Drive: Electric gear motor
 Motor connection via: Plug connector
 Rated voltage: 12 V DC
 Rated output: 0.75 W
 No-load current: 3.68 mA
 Starting current: 106 mA
 Connecting resistance: 114 Ohm
 Max. load current: 81 mA
 Max. torque: 54 mNm [0.477 lbf·in]
 Approx. idle speed: 180 U/min
 Noise emission: Not relevant

BOARD MARKER PROBES

Board marker probe ME-E-R2,0-12-080-S12V

Item 38371



ingun[®]

Partner for Future Technology

Accessories

Part no.	Designation	Version
27316	SWS-ME-E-R2,0	Engraver change set, scratching engraver for markings with D = 2.0 mm (including pressure spring 24454)
36797	ASV-ME-E-WK-EC	Extraction device
43637	ASK-M12-F-W-2000-0,34-004	Connector cable, M12x1, four-pole

INGUN Prüfmittelbau GmbH

Max-Stromeyer-Straße 162
78467, Constance, Germany
Phone +49 7531 8105-0
Customer hotline +49 7531 8105-888
Fax +49 7531 8105-65
info@ingun.com



Prices and delivery times on request.
Technical changes reserved. 06/26_GB

Learn more about
Board marker probes



ingun.com