

Test Probe INGUN E-Type

E-100 214 050 A 3000

Item E-100-0028



GO TO PRODUCT

ingun[®]

Partner for Future Technology

- Highest contact reliability under challenging test conditions without additional stress on the DUT: up to 25% larger contact surface between test probe and DUT
- When hitting the test surface a spring force up to 100% higher than a standard GKS is available, but the same spring force as a standard GKS is achieved at the working stroke.
- Dimensions equivalent to the standard GKS series

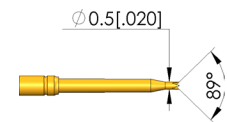
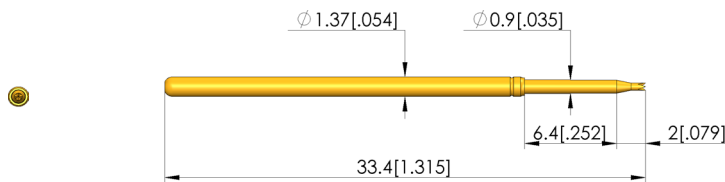
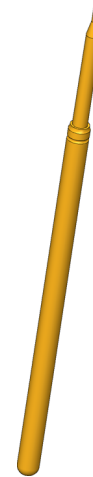

General data

Product group:	ICT / FCT (in-circuit test and function test)
Sub-product group:	INGUN E-TYPE®
Series:	E-100
Grid:	2.54 mm [100 mil]
Contacting from:	Pad
Magnetic:	Yes
Installation type:	Plug-in
Quick-exchange system:	Yes
Adjustable installation height:	No
Non-rotating:	No
Compatible receptacle(s):	KS-100
Min. temperature:	-40 °C [-40 °F]
Max. temperature:	80 °C [176 °F]
RoHS-compliant:	Yes

Tip style data

Tip style:	14 4-point crown, self-cleaning
Tip diameter:	0.5 mm [.019 in]
Tip style surface:	A gold
Tip style material:	2 steel

Electrical data

Current load capacity / rated current:	5 A
Typical resistance (Ri):	20 mOhm

Mechanical data

Total length:	33.4 mm [1.31 in]
Barrel diameter:	1.37 mm [.053 in]
Maximum stroke:	6.35 mm [.25 in]
Spring pre-load:	1.87 N [6.72 ozf]
Collar height:	00
Spring force at working stroke:	3 N [10.7 ozf]
Recommended working stroke:	4.3 mm [.169 in]

Test Probe INGUN E-Type

E-100 214 050 A 3000

Item E-100-0028



GO TO PRODUCT

ingun[®]

Partner for Future Technology

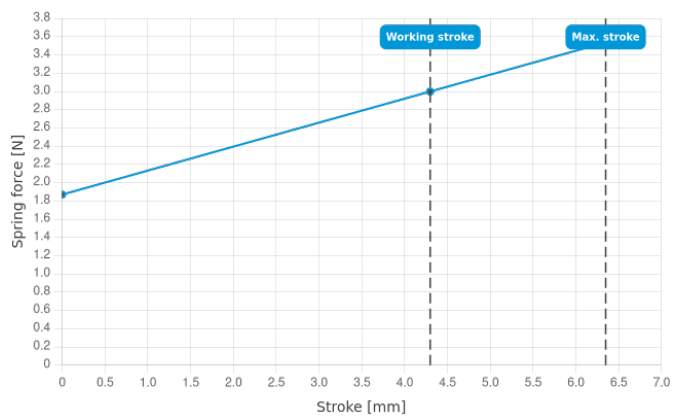

INGUN Prüfmittelbau GmbH

Max-Stromeyer-Straße 162
78467, Constance, Germany
Phone +49 7531 8105-0
Customer hotline +49 7531 8105-888
Fax +49 7531 8105-65
info@ingun.com



Prices and delivery times on request.
Technical changes reserved. 05/26_GB

Learn more about
ICT/FCT Test probes



ICT/FCT TEST PROBES

ingun.com