

Spring-loaded tooling pin

GFS-4,50-RD-25-06,5-B

Item 21824



GO TO PRODUCT

ingun®

Partner for Future Technology

- Trusted tooling pin for reliable, spring-loaded mounting of the PCB via the guide holes
- High-precision and low-wear
- Optimum tolerance compensation
- Compact design with external spring

Application

Spring-loaded tooling pins (GFS) are used to spring-load the PCB to be tested via the guide holes and position it precisely in the probe field on the contacting plane.

Note:

The spring-loaded tooling pin is mounted in the probe plate (KTP) and must be positioned with the collar flush to the surface of the probe plate.

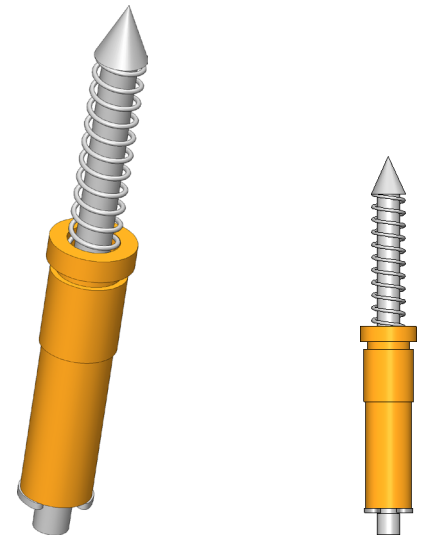

1:1

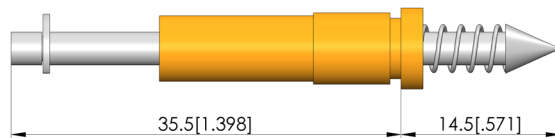
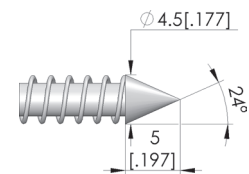
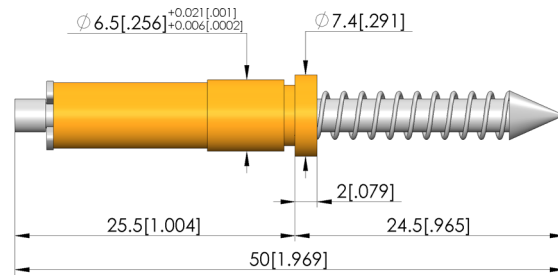

Spring-loaded tooling pin

GFS-4,50-RD-25-06,5-B

Item 21824



GO TO PRODUCT

ingun[®]

Partner for Future Technology

General data

| | |
|-------------------|---|
| Product group: | Tooling pins |
| Series: | FS-GF |
| Type: | Spring-loaded |
| Version: | Round with collar (D7.4x2), probe plate (KTP) |
| Accessory type: | Customising accessories |
| Weight: | 1 kg [2.2 lbs] |
| Min. temperature: | 10 °C [50 °F] |
| Max. temperature: | 60 °C [140 °F] |
| RoHS-compliant: | Yes |

Technical data

| | |
|---------------|------------------|
| Stroke: | 10 mm [.393 in] |
| Tip diameter: | 4.5 mm [.177 in] |
| Force: | 6 N [21.5 ozf] |
| Installation: | Plugged |
| Spring force: | 6 N [21.5 ozf] |
| Length: | 50 mm [1.96 in] |
| Tip height: | 5 mm [.196 in] |
| Diameter: | 7.4 mm [.291 in] |
| Pin diameter: | 6.5 mm [.255 in] |

Compatible with

| | |
|--------------------------------|----------------|
| Exchangeable kits version: | No limitations |
| Manual test fixtures (MA): | MA 2012 |
| Vacuum test fixtures (VA): | VA 30xx |
| MA exchangeable kits (ATS MA): | ATS MAxx |
| PA exchangeable kits (ATS PA): | ATS PAZxxx |
| Interchangeable kits (WS): | WS |

INGUN Prüfmittelbau GmbH

Max-Stromeyer-Straße 162
78467, Constance, Germany
Phone +49 7531 8105-0
Customer hotline +49 7531 8105-888
Fax +49 7531 8105-65
info@ingun.com



Prices and delivery times on request.
Technical changes reserved. 06/26_GB