

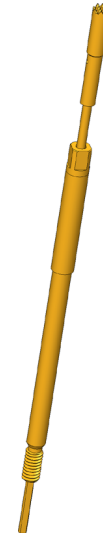

Verrastprüfung

Zur Überprüfung der korrekten Verrastung des Kontaktterminals im Steckergehäuse



1:1

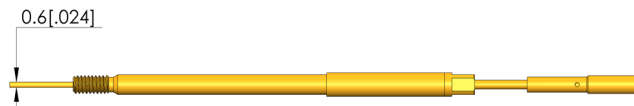
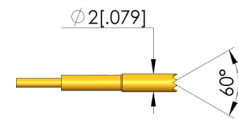
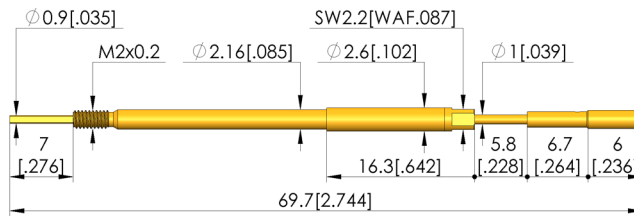
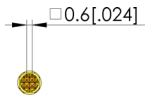

General data

Screw-in torque max.:
 Product group:
 Sub-product group:
 Series:
 Grid:
 Contacting from:
 Magnetic:
 Installation type:
 Quick-exchange system:
 Adjustable installation height:
 Non-rotating:
 Continuous plunger:
 Screw-in torque:
 Compatible receptacle(s):
 Min. temperature:
 Max. temperature:
 RoHS-compliant:

5 cNm [.442 lbf-in]
 Push-back probes
 Push-back probes
 VF3
 3 mm [118 mil]
 Post
 Yes
 Screw-in
 Yes
 No
 Yes
 $\emptyset 0,9 \times 0,6 \times 7,0$
 3 – 5 cNm [.265 – .442 lbf-in]
 KS-VF3
 -40 °C [-40 °F]
 80 °C [176 °F]
 Yes

Tip style data

Tip style: 06 serrated
 Tip diameter: 2 mm [.078 in]
 Tip style surface: A gold
 Tip style material: 2 steel

Electrical data

Current load capacity / rated current: 8 A
 Typical resistance (Ri): 30 mOhm

Mechanical data

Total length: 69.7 mm [2.74 in]
 Barrel diameter: 2.19 mm [.086 in]
 Maximum stroke: 5.5 mm [.216 in]
 Spring pre-load: 5.96 N [21.4 ozf]
 Spring force at working stroke: 15 N [53.9 ozf]
 Recommended working stroke: 5 mm [.196 in]

SCREW-IN TEST PROBE

Test Probe

VF3-206 200 A 405 15

Item VF3-0029



GO TO PRODUCT

ingun®

Partner for Future Technology

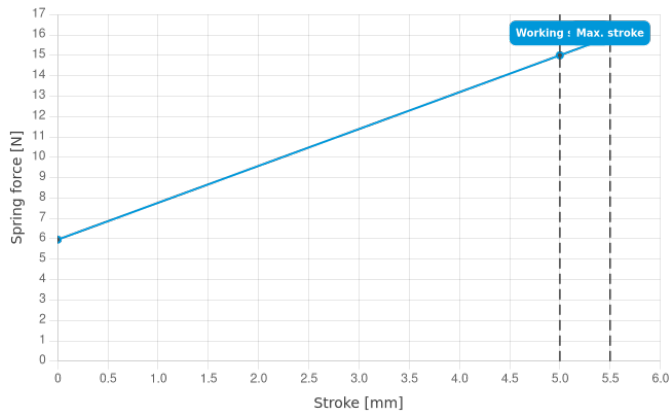

INGUN Prüfmittelbau GmbH

Max-Stromeyer-Straße 162
78467, Constance, Germany
Phone +49 7531 8105-0
Customer hotline +49 7531 8105-888
Fax +49 7531 8105-65
info@ingun.com



Prices and delivery times on request.
Technical changes reserved. 06/26_GB

Learn more about
Screw-in test probe



SCREW-IN TEST PROBE

ingun.com