

Receptacle

KS-112 47

Item KS-11247



GO TO PRODUCT

ingun[®]

Partner for Future Technology

INGUN SELECTION

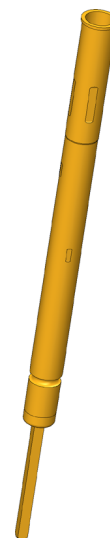

1:1

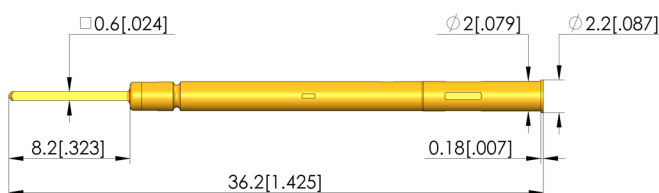

General data

Product group:
Series:
Sub-series:
Type of receptacle connection:
Press ring:
Surface area:
Collar diameter:
Collar height:
Wire-wrap post length:
Knurl:
Vacuum-tight:
RoHS-compliant:

Receptacles (KS)
KS-112
KS-112 press-in version
Wire-wrap
No
Gold
2.2 mm [.086 in]
0.2 mm [.007 in]
8.2 mm [.322 in]
No
yes (< 1 ccm / min)
Yes

Mechanical data

Total length: 36.2 mm [1.42 in]
Outer diameter: 2 mm [.078 in]

Mounting hole

Mounting hole in CEM1: 1.98 - 2 mm [.077 - .078 in]
Mounting hole in FR4: 1.99 - 2.01 mm [.078 - .079 in]

INGUN Prüfmittelbau GmbH

Max-Stromeyer-Straße 162
78467, Constance, Germany
Phone +49 7531 8105-0
Customer hotline +49 7531 8105-888
Fax +49 7531 8105-65
info@ingun.com



Prices and delivery times on request.
Technical changes reserved. 06/26_GB

Learn more about
Test probes



ingun.com