

# Test plug

## PS-RJ45-M-008-M3-B

Item 55140



GO TO PRODUCT

**ingun**<sup>®</sup>

Partner for Future Technology

- Compatible test plug mount 115788, 115790, 115792, 115794
- Precise, low-wear contacting of RJ plug connectors
- Outstanding service life: up to 250,000 cycles under optimal conditions.
- Reliable data transmission
- Optional: Installation via floating mount
- Signal transmission via original connector plug

### INGUN SELECTION

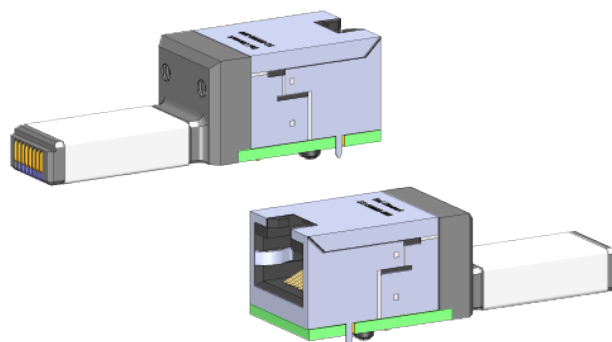

#### General data

Product group:	PS test plug
Series:	PS
Sub-series:	PS-RJ
DUT / contact:	RJ-45
DUT interface gender :	F signal conductor female / socket
KS sub-series:	PSA-F16,5-RJxx
Width:	17 mm [.669 in]
Height:	17 mm [.669 in]
Min. temperature:	-40 °C [-40 °F]
Max. temperature:	75 °C [167 °F]
RoHS-compliant:	Yes

#### Inner conductor data

Inner conductor maximum stroke:	1.5 mm [.059 in]
Number of inner conductor poles:	8

#### Electrical data

Max. data rate:	1 Gbit/s
-----------------	----------

#### Mechanical data

Total length:	52 mm [2.04 in]
---------------	-----------------

Test plug

PS-RJ45-M-008-M3-B

Item 55140



GO TO PRODUCT

ingun®

Partner for Future Technology

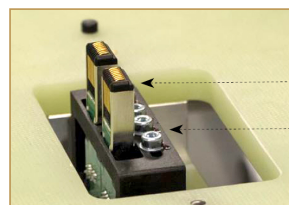
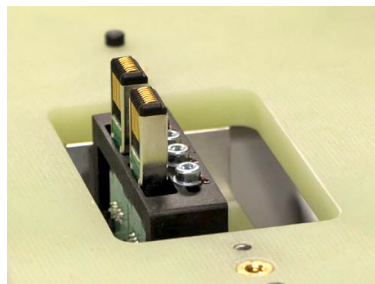

Test plug (part 55140)

Test plug mounting (part 55148)



Part no. EN	Designation	Tip version EN
115788	PSA-F16,5-26N-2,6-2M3-V28	Prüfsteckeraufnahme
115790	PSA-F16,5-26N-2,6-2M3-H26	Prüfsteckeraufnahme
115792	PSA-16,5-26N-2,6-2M3-H39-2H	Prüfsteckeraufnahme
115794	PSA-F16,5-26N-2,6-2M3-V28-2H	test plug mounting

### INGUN Prüfmittelbau GmbH

Max-Stromeyer-Straße 162  
78467, Constance, Germany  
Phone +49 7531 8105-0  
Customer hotline +49 7531 8105-888  
Fax +49 7531 8105-65  
info@ingun.com



Prices and delivery times on request.  
Technical changes reserved. 07/26\_GB

Learn more about  
Test probes

