

# Test Probe

## GKS-100 306 150 A 3000

Item GKS-100-0026



GO TO PRODUCT

ingun®

Partner for Future Technology

- Well-established test probes for contacting PCBs
- For optimal contact to the test points (e.g. pads, vias, and pins), various tip styles with various diameters and finishes are available.
- Various spring forces available as well as versions with stainless steel springs suitable for high temperatures
- Used for setting the optimum stroke conditions in the test fixture, various installation heights can be achieved by combining test probes and receptacles

### INGUN SELECTION

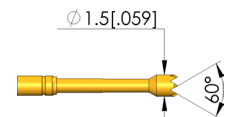
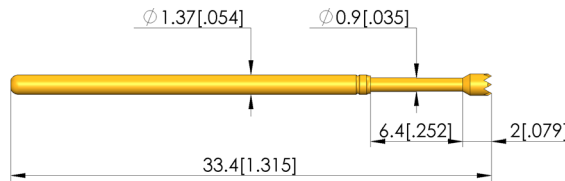
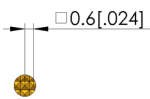
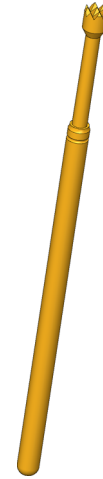

#### General data

Product group: ICT / FCT (in-circuit test and function test)  
Sub-product group: Standard stroke test probe  
Series: GKS-100  
Grid: 2.54 mm [100 mil]  
Contacting from: Post  
Magnetic: Yes  
Installation type: Plug-in  
Quick-exchange system: Yes  
Adjustable installation height: No  
Non-rotating: No  
Compatible receptacle(s): KS-100  
Min. temperature: -40 °C [-40 °F]  
Max. temperature: 80 °C [176 °F]  
RoHS-compliant: Yes

Product group: ICT / FCT (in-circuit test and function test)  
Sub-product group: Standard stroke test probe  
Series: GKS-100  
Grid: 2.54 mm [100 mil]  
Contacting from: Post  
Magnetic: Yes  
Installation type: Plug-in  
Quick-exchange system: Yes  
Adjustable installation height: No  
Non-rotating: No  
Compatible receptacle(s): KS-100  
Min. temperature: -40 °C [-40 °F]  
Max. temperature: 80 °C [176 °F]  
RoHS-compliant: Yes

#### Tip style data

Tip style: 06 serrated  
Tip diameter: 1.5 mm [.059 in]  
Tip style surface: A gold  
Tip style material: 3 CuBe

06 serrated  
1.5 mm [.059 in]  
A gold  
3 CuBe

#### Electrical data

Current load capacity / rated current: 8 A  
Typical resistance (Ri): 20 mOhm

8 A  
20 mOhm

#### Mechanical data

Total length: 33.4 mm [1.31 in]  
Barrel diameter: 1.37 mm [.053 in]  
Maximum stroke: 6.35 mm [.25 in]  
Spring pre-load: 0.78 N [2.8 ozf]  
Collar height: 00  
Spring force at working stroke: 3 N [10.7 ozf]  
Recommended working stroke: 4.3 mm [.169 in]

#### INGUN Prüfmittelbau GmbH

Max-Stromeyer-Straße 162  
78467, Constance, Germany  
Phone +49 7531 8105-0  
Customer hotline +49 7531 8105-888  
Fax +49 7531 8105-65  
info@ingun.com



Prices and delivery times on request.  
Technical changes reserved. 07/26\_GB

Learn more about  
ICT/FCT Test probes



ingun.com