

Receptacle

KS-150 M3 M3-R

Item KS-150M3M3-R



GO TO PRODUCT

ingun[®]

Partner for Future Technology

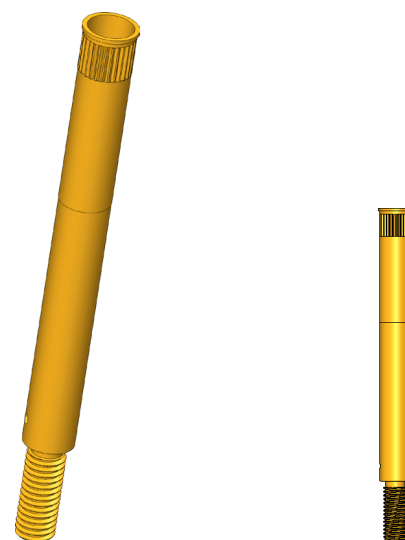

1:1

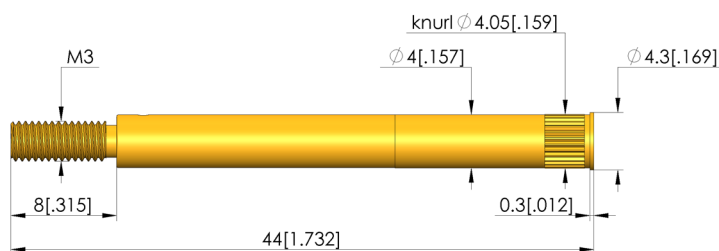

General data

Product group: Receptacles (KS)
 Series: KS-150
 Sub-series: KS-150 M screw-in version
 Type of receptacle connection: Thread (M)
 Press ring: No
 Surface area: Gold
 Collar diameter: 4.3 mm [.169 in]
 Collar height: 0.3 mm [.011 in]
 Knurl: Yes
 Vacuum-tight: No
 RoHS-compliant: Yes

Mechanical data

Total length: 44 mm [1.73 in]
 Outer diameter: 4 mm [.157 in]

Mounting hole

Mounting hole in CEM1: 4 - 4.02 mm [.157 - .158 in]
 Mounting hole in FR4: 4 - 4.02 mm [.157 - .158 in]

INGUN Prüfmittelbau GmbH

Max-Stromeyer-Straße 162
 78467, Constance, Germany
 Phone +49 7531 8105-0
 Customer hotline +49 7531 8105-888
 Fax +49 7531 8105-65
 info@ingun.com



Prices and delivery times on request.
 Technical changes reserved. 06/26_GB

Learn more about
 Test probes



RECEPTACLES

ingun.com