

Test Probe

GKS-135 306 130 A 2000

Item GKS-135-0017



GO TO PRODUCT

ingun[®]

Partner for Future Technology

- Long-stroke test probe for implementing combined ICT and FCT in a dual-stage fixture
- For optimum contact at the test points (e.g. pads, vias, and pins), various tip styles in different diameters and finishes, as well as various spring forces are available. Spring forces.
- Used for setting the optimum stroke conditions in the test fixture, various installation heights can be achieved by combining test probes and receptacles

Note:

Receptacles in the series KS-100 are used for the GKS-135 test probes series.



1:1

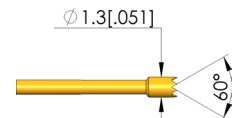
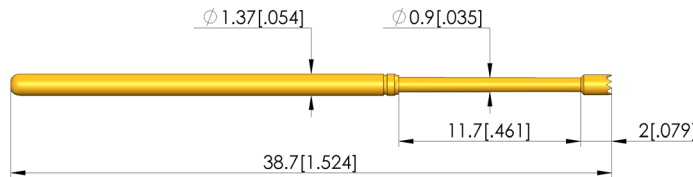
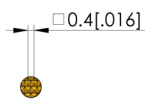

General data

Product group:	ICT / FCT (in-circuit test and function test)
Sub-product group:	Long stroke GKS
Series:	GKS-135
Grid:	2.54 mm [100 mil]
Contacting from:	Post
Magnetic:	Yes
Installation type:	Plug-in
Quick-exchange system:	Yes
Adjustable installation height:	No
Non-rotating:	No
Compatible receptacle(s):	KS-100
Min. temperature:	-40 °C [-40 °F]
Max. temperature:	80 °C [176 °F]
RoHS-compliant:	Yes

Tip style data

Tip style:	06 serrated
Tip diameter:	1.3 mm [.051 in]
Tip style surface:	A gold
Tip style material:	3 CuBe

Electrical data

Current load capacity / rated current:	5 A
Typical resistance (Ri):	30 mOhm

Mechanical data

Total length:	38.7 mm [1.52 in]
Barrel diameter:	1.37 mm [.053 in]
Maximum stroke:	11.5 mm [.452 in]
Spring pre-load:	0.21 N [.755 ozf]
Collar height:	00
Spring force at working stroke:	2 N [7.19 ozf]
Recommended working stroke:	9.3 mm [.366 in]

Test Probe

GKS-135 306 130 A 2000

Item GKS-135-0017



GO TO PRODUCT

ingun®

Partner for Future Technology

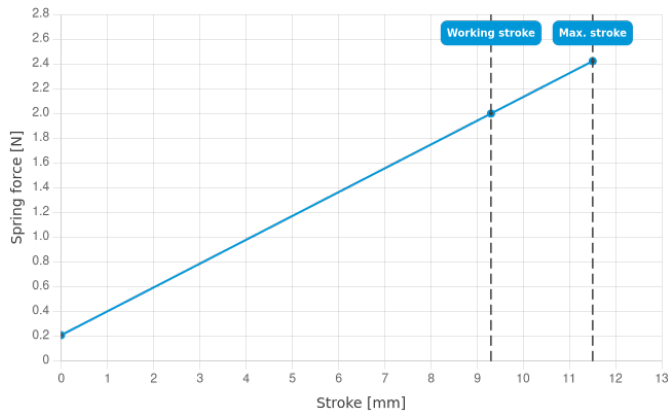

INGUN Prüfmittelbau GmbH

Max-Stromeyer-Straße 162
78467, Constance, Germany
Phone +49 7531 8105-0
Customer hotline +49 7531 8105-888
Fax +49 7531 8105-65
info@ingun.com



Prices and delivery times on request.
Technical changes reserved. 05/26_GB

Learn more about
ICT/FCT Test probes



ingun.com