

# ESD discharge probe

## FB-ALS-VA207x

Item 22111



GO TO PRODUCT

**ingun**<sup>®</sup>

Partner for Future Technology

- Reliable dissipation of electrostatic discharges that occur as a result of potential differences
- Quick, easy installation

### Application

The ESD discharge contact is used for the reliable discharge of any electrostatic discharges that may occur as a result of potential differences. It is installed in the probe plate and the moving plate.

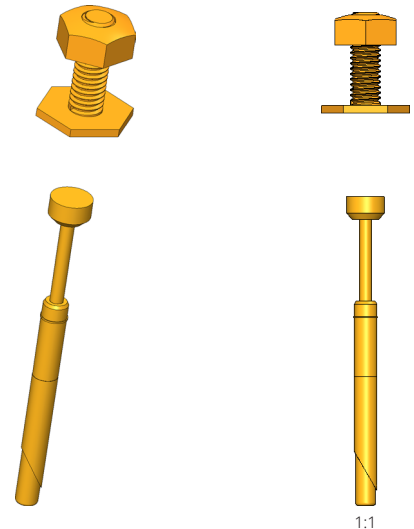

1:1

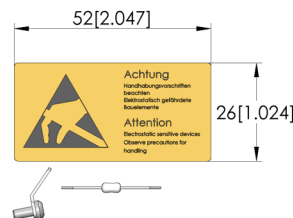
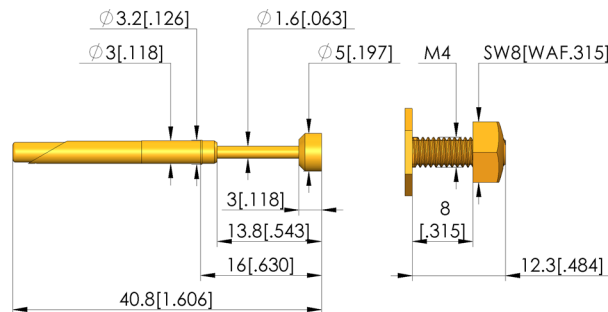

### General data

Product group:  
Series:  
Type:  
Version:  
Accessory type:  
Scope of delivery:  
Component assembly:  
Weight:  
Min. temperature:  
Max. temperature:  
RoHS-compliant:

Functional units  
FB-VAxxxx  
ESD discharge contact  
Single-stage contacting  
Customising accessories  
Unassembled  
GKS-414-0007  
0.01 kg [0.22 lbs]  
10 °C [50 °F]  
60 °C [140 °F]  
Yes

### Compatible with

Vacuum test fixtures (VA):  
Interchangeable kits (WS):

VA 3070

### Technical data

Stroke:  
Length:  
Diameter:

10 mm [.393 in]  
40.8 mm [1.6 in]  
3 mm [.118 in]

ESD discharge probe

**FB-ALS-VA207x**

Item 22111



GO TO PRODUCT

**ingun**<sup>®</sup>

Partner for Future Technology

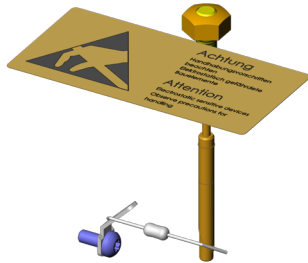

**INGUN Prüfmittelbau GmbH**

Max-Stromeyer-Straße 162  
78467, Constance, Germany  
Phone +49 7531 8105-0  
Customer hotline +49 7531 8105-888  
Fax +49 7531 8105-65  
info@ingun.com



Prices and delivery times on request.  
Technical changes reserved. 06/26\_GB

Learn more about  
Test fixture kits

